

2008 NELSON DRIVE - TRF

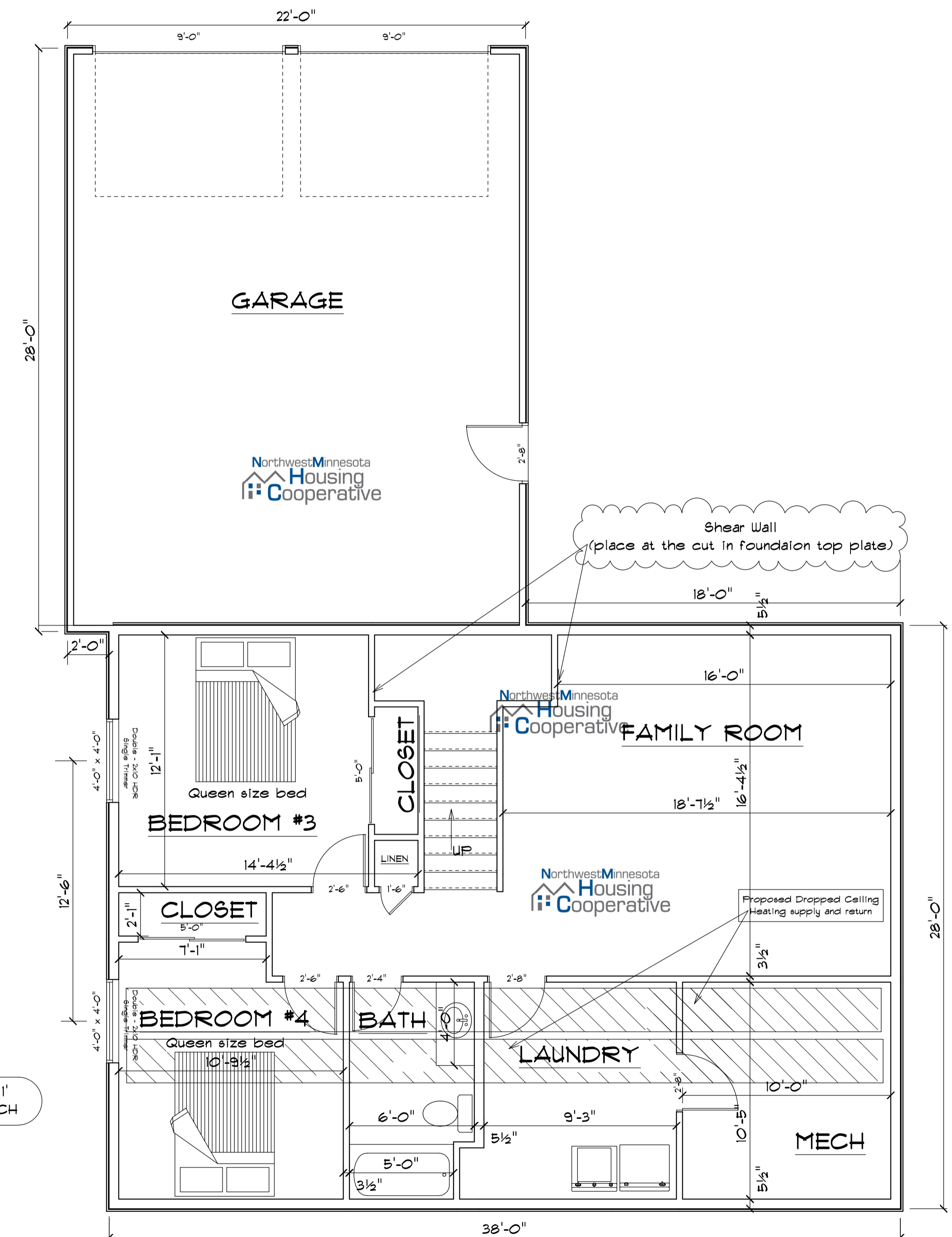

Construction MGR - Jeff Fagerstrom
681-2340
License MN#BC139312

Bidding Specs:
Full depth foundation / rambler
Basement unfinished (except laundry & Mech)
Bid option to frame non-bearing basement walls
Bid option to finish electrical in basement & garage
garage unfinished - Install 2 openers on overhead doors
Bid option to insulate and sheetrock garage
Spray foam foundation and main floor walls
Sheetrock exterior foundation walls
Note the 8' ceiling and no vault
Asphalt Driveway - concrete sidewalk & Patio
2x6 Exterior house walls, 2x4 garage walls

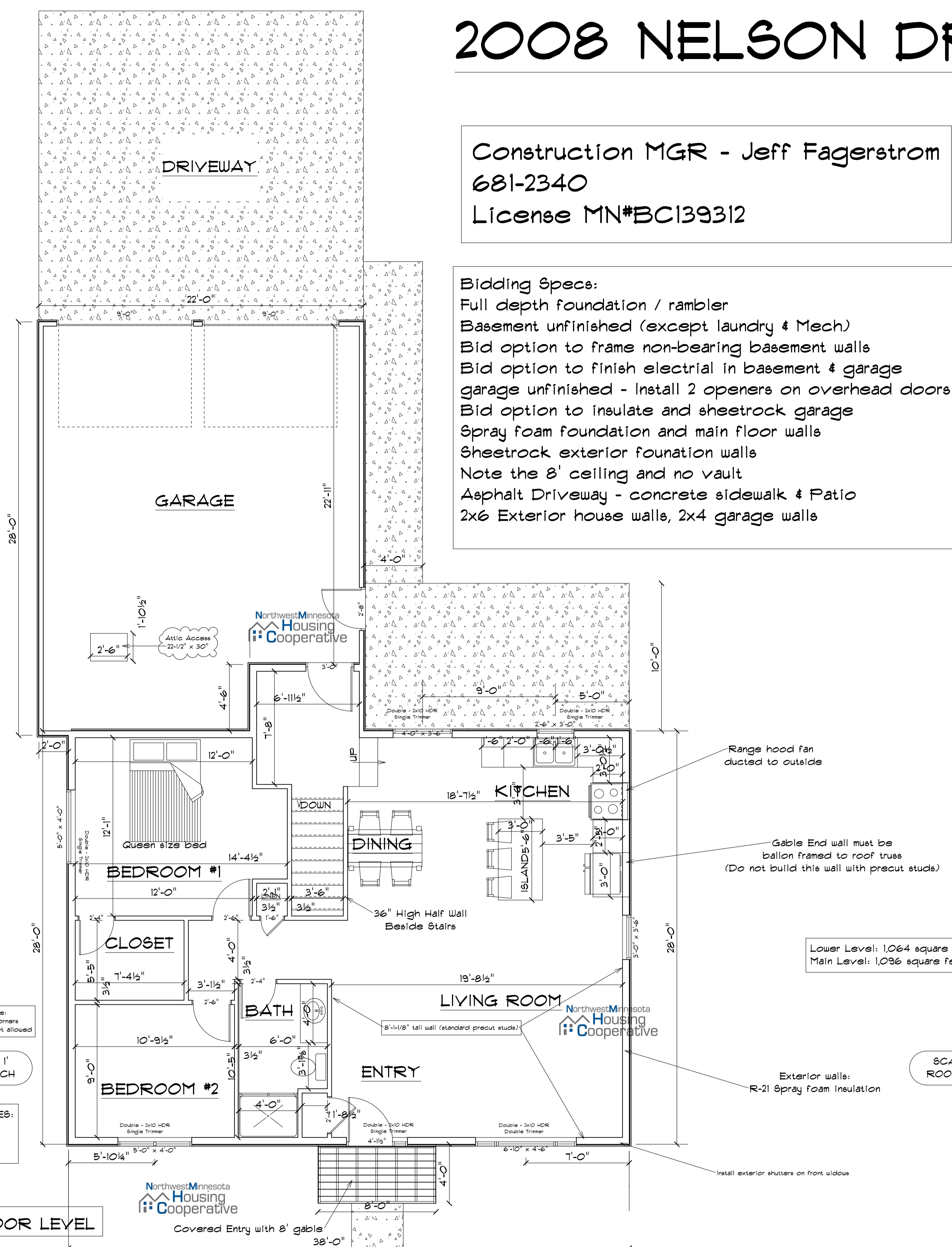

Framing Detail Note:
U-shape or L-shape corners
Concealed corners are not allowed

SCALE 1/4" = 1'
ROOF 5/12 PITCH

PLAN UPDATES:
JF - 7-5-22
JF - 7-19-22

MAIN FLOOR LEVEL

BBN NMHC OS2.2
Main Floor

Lower Level: 1,064 square feet
Main Level: 1,096 square feet

SCALE 1/4" = 1'
ROOF 5/12 PITCH



LOWER LEVEL

BBN NMHC OS2.2
Lower Level

